

## USEFUL INFORMATION

These hanging instructions are provided to aid you in correctly hanging your new ohpopsi mural, please read carefully prior to cutting or hanging this product. Double check the product information on the roll to ensure you have the correct size and design before opening your mural. If any part of the mural is defective do not proceed to hang.

### PREPARING YOUR WALL

Wall surfaces should be clean, dry and smooth prior to hanging your wall mural. If papering on to a freshly plastered wall we recommend painting with a suitable primer prior to hanging to ensure that the paste adheres sufficiently to the paper.

Any holes, cracks or lumps and bumps should be filled with a good quality filler, smoothed out to create a level surface and sanded once dry.

Brush off the area to be covered with your OHPOPSI mural using a stiff brush to remove any dust, debris and all loose material.

We do not recommend applying your mural to an already papered wall. Any wallpaper already on the wall surface should be stripped and any remaining adhesive removed. This should be followed by the preparation steps listed above here.

To achieve the best finish for your wall mural apply to a plaster surface that has been painted with one coat of builder's primer and one coat of emulsion paint, both are readily available from any DIY store.

### TOOLS YOU WILL NEED TO HANG OHPOPSI WALLPAPER

**Paste-the-wall wallpaper paste**

**Paste brush or roller** to apply the paste

**A soft dry cloth** to clear any debris or dust from the wall

A lightly dampened **cloth or sponge** to wipe off excess paste

**Sharp knife** to cut the paper

**Spirit level or plumb line**

**Pencil** to mark your starting point

**Tape measure or ruler**

**Stepladder**

**Soft bristled brush** to smooth out wallpaper

**Artist chalk or pastel** to prevent white edges showing at the seams, dark coloured wallpapers may need their edges colouring with a slightly lighter chalk or pastel once the paper has dried.

## HANGING INSTRUCTIONS

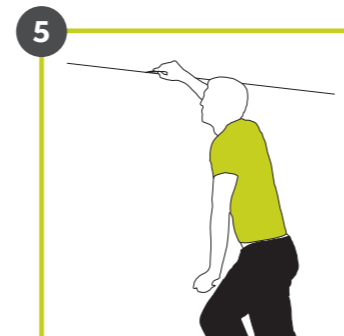
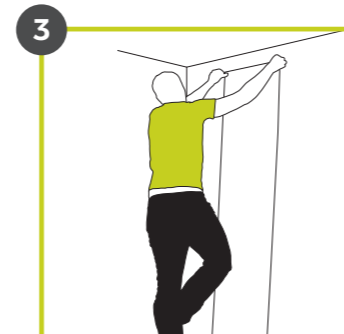
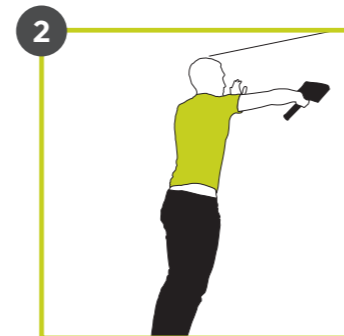
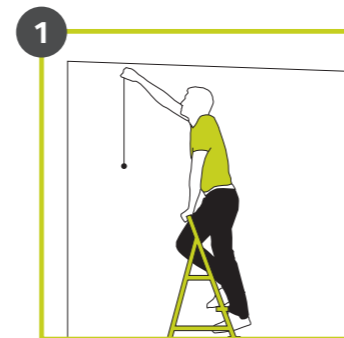

### STEP 1: MEASURE AND PLAN WHERE TO START

After checking your wall mural cut the mural header at the indicated cut line to separate the header from the start of the first design strip and retain for your reference. Cut each strip from the roll and line up on flat surface to ensure that the mural design is complete and hung in the correct order.

### STEP 2: APPLY THE WALLPAPER PASTE TO THE WALL

The first strip to be hung must be applied to the wall straight, a spirit level is highly recommended to assist you in achieving this as every subsequent strip will be affected by the placement of the first. Working from left to right, using a pencil mark the wall at the paper width's edge and using a spirit level draw a vertical line all the way down the wall, this will ensure that your first strip is hung as straight as possible.

### STEP 3: APPLY THE WALLPAPER TO THE WALL

Apply the wallpaper paste to the wall with a paste brush or roller, pasting beyond the plumb line (drawn with the aid of a spirit level) and making sure that you apply paste a couple of centimetres wider than the mural strip you are about to hang.

### STEP 4: SMOOTH OUT THE WALLPAPER

Use a ladder to hang the first strip from the top of the wall (below any coving) to the bottom of the wall. Once you are happy with the position of the first strip, smooth down the paper with a soft bristled brush working outwards from the centre, down the length of the drop to remove any trapped air pockets down to the skirting board. If you need to reposition the strip do so gently and whilst the adhesive is still wet.

### STEP 5: PASTE AND REPEAT

Continue to paste the wall section by section and hang each strip from top to bottom lining up the design in each strip. In a size Large mural there will be 6 strips in total and in an Extra Large mural there will be 7 strips. Each strip should be hung with a closely butted seam so that there are no gaps but do not overlap. Once you have smoothed out the final strip, cut any excess length from the bottom of the mural. Ensure that any excess paste is gently wiped from the surface of the paper using a lightly dampened cloth, before the adhesive dries.